

**Experion**

**Honeywell**

**Getting started with Experion Process  
Knowledge System (PKS)**

<b>Document</b>	<b>Release</b>	<b>Issue</b>	<b>Date</b>
EP-DCSX23	210	0	November 2004

## **Notice**

This document contains Honeywell proprietary information. Information contained herein is to be used solely for the purpose submitted, and no part of this document or its contents shall be reproduced, published, or disclosed to a third party without the express permission of Honeywell Limited Australia.

While this information is presented in good faith and believed to be accurate, Honeywell disclaims the implied warranties of merchantability and fitness for a purpose and makes no express warranties except as may be stated in its written agreement with and for its customer.

In no event is Honeywell liable to anyone for any direct, special, or consequential damages. The information and specifications in this document are subject to change without notice.

Copyright 2004 – Honeywell Limited Australia

## **Honeywell trademarks**

PlantScape<sup>®</sup>, SafeBrowse<sup>®</sup>, TotalPlant<sup>®</sup>, and TDC 3000<sup>®</sup> are U.S. registered trademarks of Honeywell International Inc.

Experion and Process Knowledge System is a trademark of Honeywell International Inc.

## **Other trademarks**

Trademarks that appear in this document are used only to the benefit of the trademark owner, with no intention of trademark infringement.

# Welcome

This *Getting Started with Experion* guide is a roadmap to help you achieve your Experion Process Knowledge System (PKS) installation or upgrade faster and more efficiently.

## How to use this guide

There is an overview page for the most common installation and upgrade scenarios. Each overview page identifies the high-level steps you must complete. Most high-level steps reference a checklist in the *Experion PKS Software Installation and Upgrade Guide*. These checklists describe the sequence of tasks to complete.

Each overview page also contains a “References” and “Complete these forms” section.

### References

The “References” section on each overview page lists the documents that you need to complete the installation or upgrade. You should have these documents available *before* you begin.

### Complete these forms

The “Complete these forms” section on each overview page lists the specification forms that you must filled in for the installation or upgrade. These specification forms are located in the *Experion PKS Software Installation and Upgrade Guide*, and help you to gather details that you will need to enter during the installation or upgrade.

# Contents

Find the overview page for your installation or upgrade.

## R210 new installations

Installing an Experion PKS server	page 5
Installing redundant Experion PKS servers	page 6
Installing Experion PKS eServer	page 7
Installing Experion PKS ACE	page 8
Installing Experion PKS SIM-C200	page 9
Installing Mobile Access for eServer	page 10
Installing Mobile Access for Station	page 11
Installing Experion PKS Console Station	page 12
Installing Experion PKS Console Extension Station	page 13
Installing Experion PKS Flex Station	page 14

## R201 on-process migration

On-process migration of redundant Experion PKS R201 servers	page 15
---	---------

## R101/R201 upgrades

Upgrading an Experion PKS R201/R101 server	page 16
Upgrading redundant Experion PKS R201/R101 servers	page 17
Upgrading Experion PKS R201/R101 ACE	page 18
Upgrading Experion PKS R201/R101 SIM-C200	page 19
Upgrading Experion PKS R201/R101 Console Stations	page 20
Upgrading Experion PKS R201/R101 Flex Stations and other client applications	page 21

# Installing an Experion server



## References

- Before you begin, read the *Software Change Notice (SCN)* and the *Planning Guide*
- *Software Installation and Upgrade Guide*
- *Knowledge Builder*



## Complete these forms

*Software Installation and Upgrade Guide*

- Site specification form
- Server specification form
- Client specification form

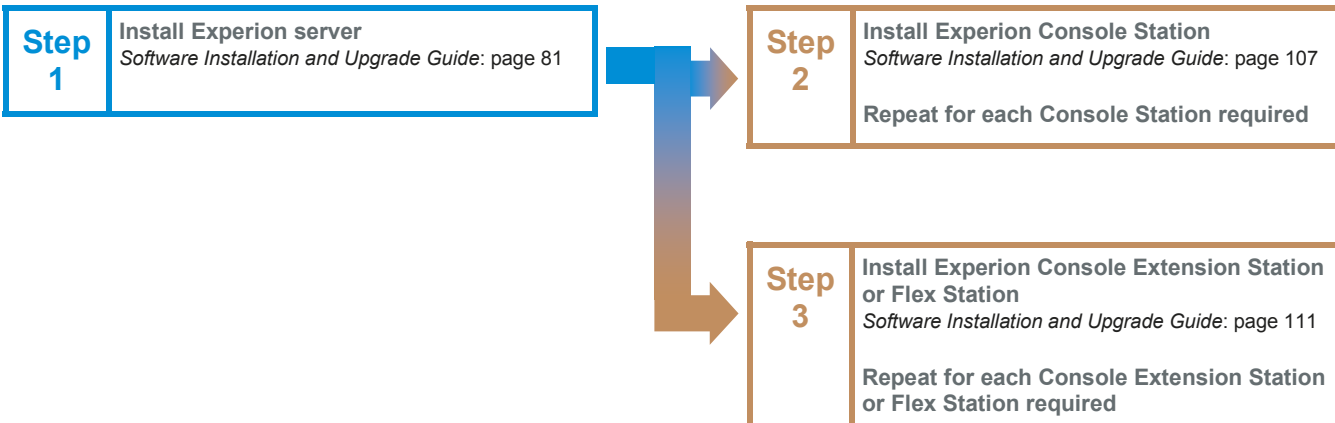

# Installing redundant Experion servers



## References

- Before you begin, read the *Software Change Notice (SCN)* and the *Planning Guide*
- *Software Installation and Upgrade Guide*
- *Knowledge Builder*



## Complete these forms

*Software Installation and Upgrade Guide*

- Site specification form
- Server specification form
- Client specification form

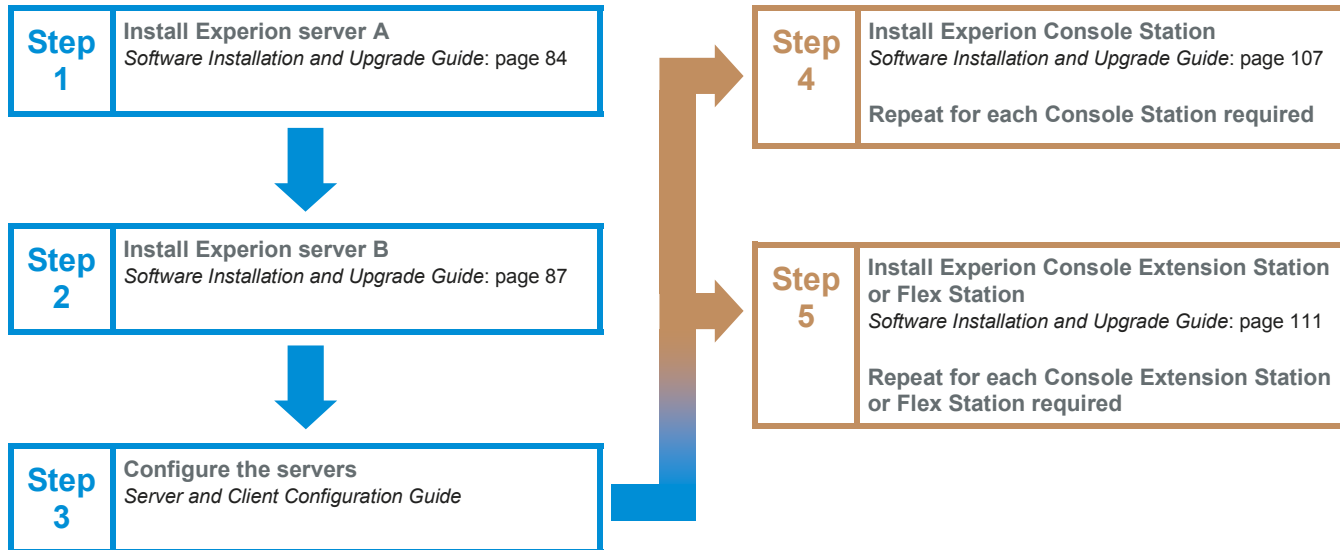

# Installing Experion eServer



## References

- Before you begin, read the *Software Change Notice (SCN)* and the *Planning Guide*
- *Software Installation and Upgrade Guide*
- *Knowledge Builder*



## Complete these forms

*Software Installation and Upgrade Guide*

- Site specification form
- Server specification form

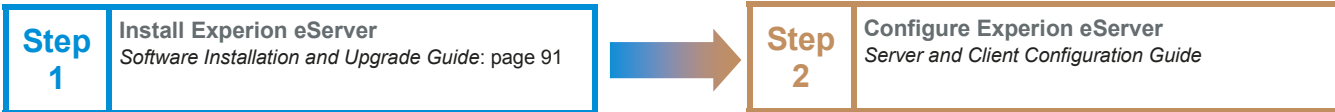

# Installing Experion ACE



## References

- Before you begin, read the *Software Change Notice (SCN)* and the *Planning Guide*
- *Software Installation and Upgrade Guide*
- *Knowledge Builder*



## Complete these forms

*Software Installation and Upgrade Guide*

- Site specification form
- Server specification form

**Step**  
**1**

## Install Experion ACE

*Software Installation and Upgrade Guide: page 93*

# Installing Experion SIM-C200



## References

- Before you begin, read the *Software Change Notice (SCN)* and the *Planning Guide*
- *Software Installation and Upgrade Guide*
- *Knowledge Builder*



## Complete these forms

*Software Installation and Upgrade Guide*

- Site specification form
- Server specification form

**Step**  
**1**

**Install Experion SIM-C200**

*Software Installation and Upgrade Guide: page 97*

# Installing Mobile Access for eServer Premium



## References

- Before you begin, read the *Software Change Notice (SCN)* and the *Planning Guide*
- *Software Installation and Upgrade Guide*
- *Knowledge Builder*



## Complete these forms

*Software Installation and Upgrade Guide*

- Site specification form
- Server specification form
- Client specification form

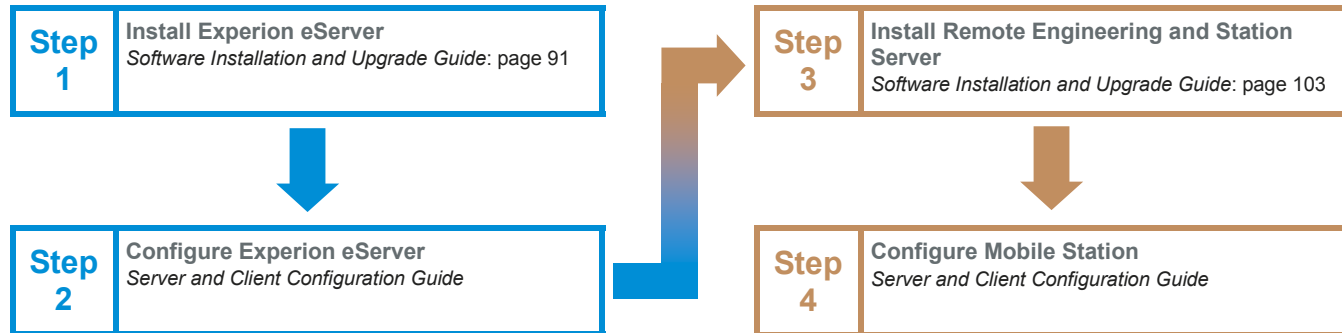

# Installing Mobile Access for Station



## References

- Before you begin, read the *Software Change Notice (SCN)* and the *Planning Guide*
- *Software Installation and Upgrade Guide*
- *Knowledge Builder*



## Complete these forms

*Software Installation and Upgrade Guide*

- Site specification form
- Server specification form
- Client specification form

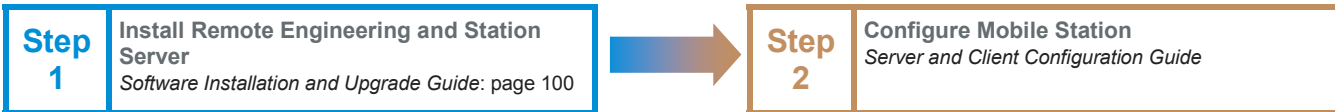

# Installing Experion Console Station



## References

- Before you begin, read the *Software Change Notice (SCN)* and the *Planning Guide*
- *Software Installation and Upgrade Guide*
- *Knowledge Builder*



## Complete these forms

*Software Installation and Upgrade Guide*

- Site specification form
- Client specification form

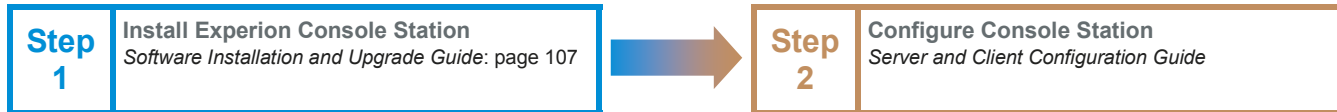

# Installing Experion Console Extension Station



## References

- Before you begin, read the *Software Change Notice (SCN)* and the *Planning Guide*
- *Software Installation and Upgrade Guide*
- *Knowledge Builder*



## Complete these forms

- Software Installation and Upgrade Guide*
- Site specification form
- Client specification form

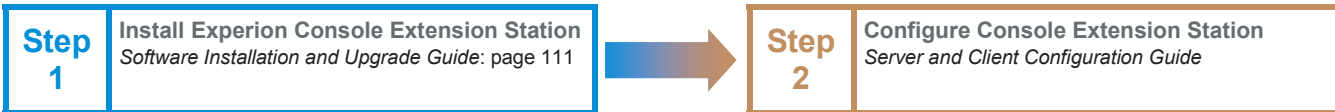

# Installing Experion Flex Station



## References

- Before you begin, read the *Software Change Notice (SCN)* and the *Planning Guide*
- *Software Installation and Upgrade Guide*
- *Knowledge Builder*



## Complete these forms

*Software Installation and Upgrade Guide*

- Site specification form
- Client specification form

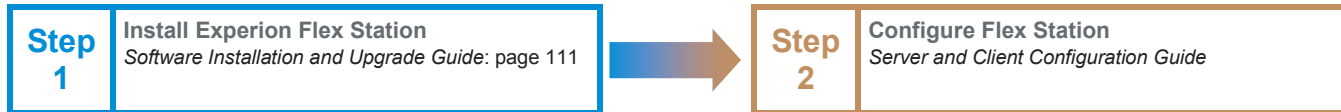

# On-process migration of redundant Experion R201 servers



## References

- Before you begin, read the *Software Change Notice (SCN)* and the *Planning Guide*
- *Software Installation and Upgrade Guide*
- *Knowledge Builder*



## Complete these forms

- Software Installation and Upgrade Guide*
- Site specification form
- Client specification form

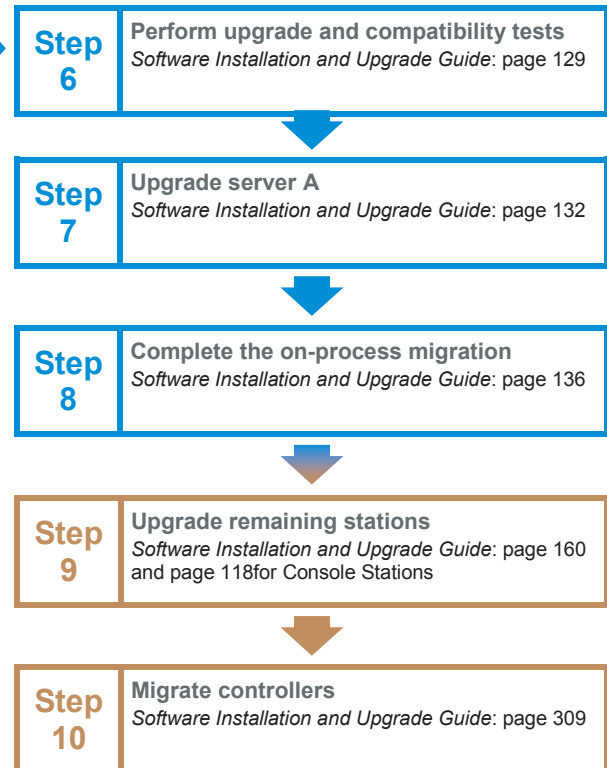
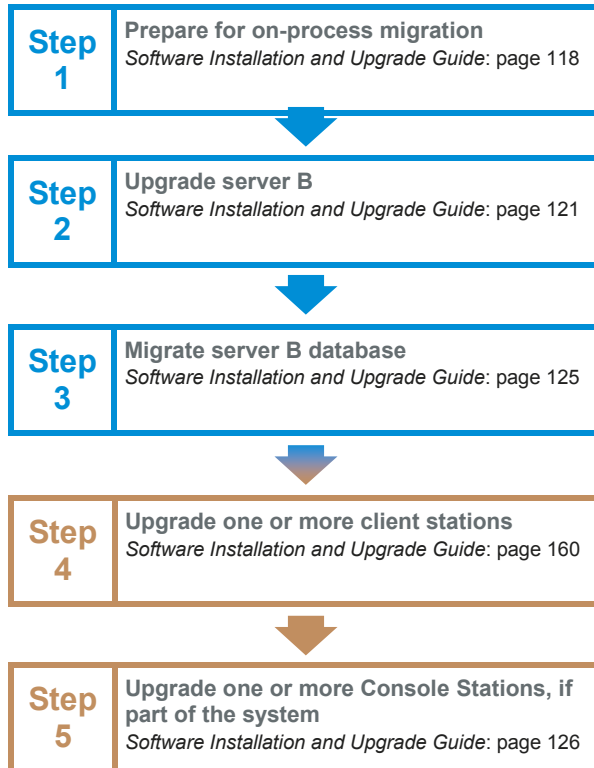

# Upgrading an Experion R101/R201 server



## References

- Before you begin, read the *Software Change Notice (SCN)* and the *Planning Guide*
- *Software Installation and Upgrade Guide*
- *Knowledge Builder*



## Complete these forms

- *Software Installation and Upgrade Guide*
- Site specification form

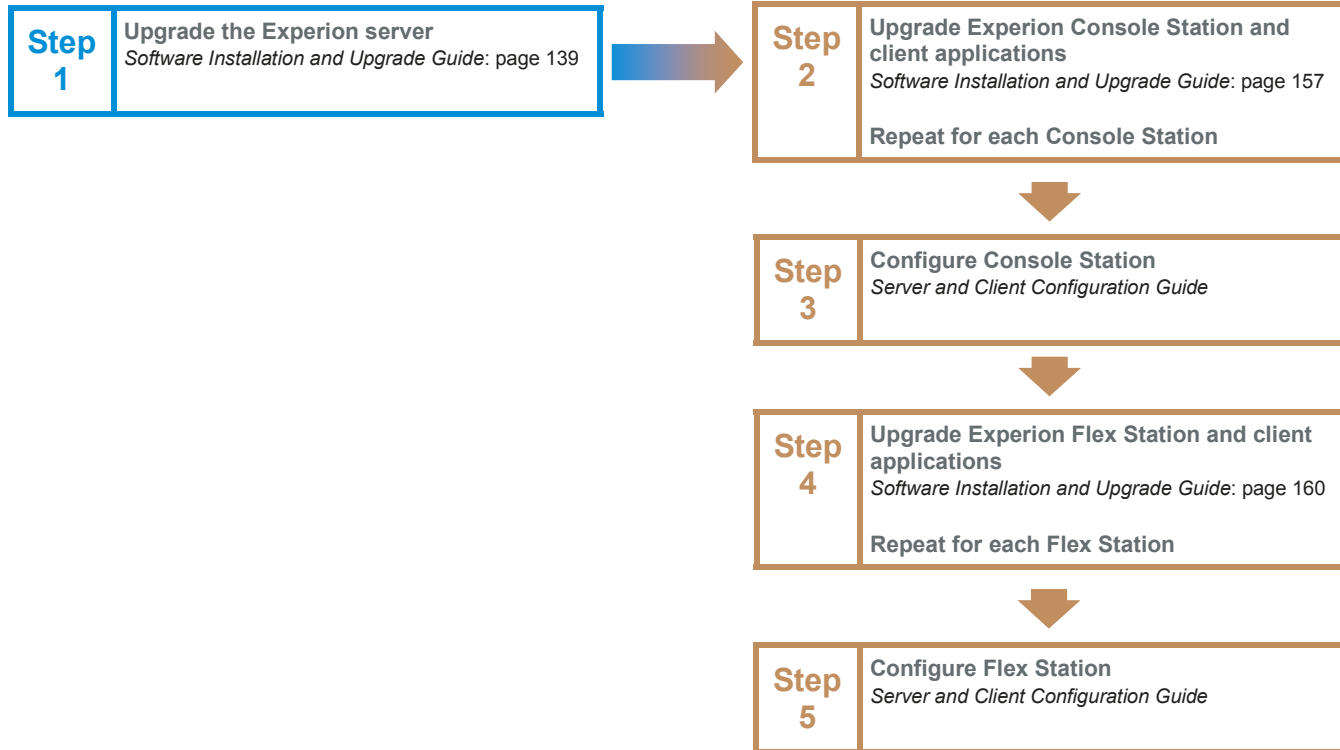

# Upgrading redundant Experion R101/R201 servers



## References

- Before you begin, read the *Software Change Notice (SCN)* and the *Planning Guide*
- *Software Installation and Upgrade Guide*
- *Knowledge Builder*



## Complete these forms

- Software Installation and Upgrade Guide*
- Site specification form

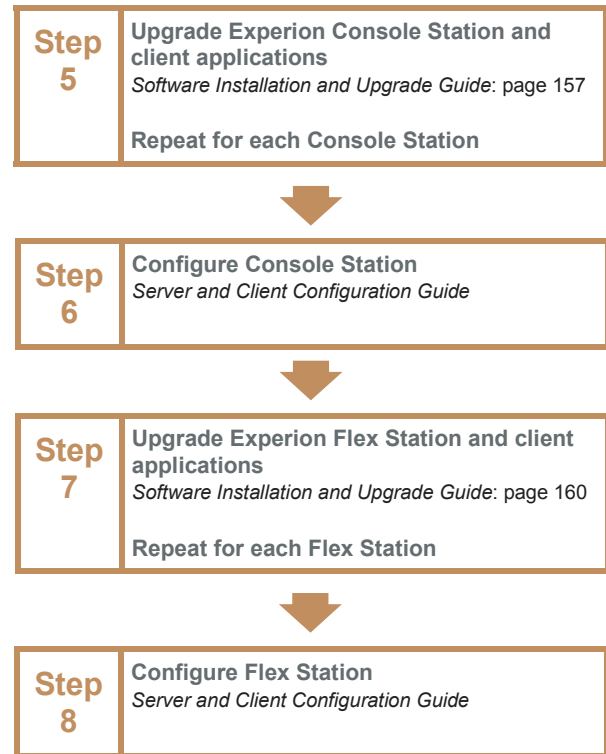
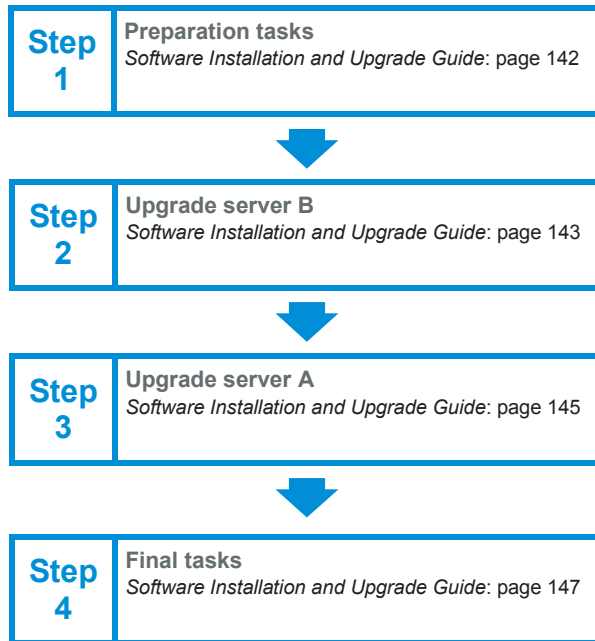

# Upgrading Experion R101/R201 ACE



## References

- Before you begin, read the *Software Change Notice (SCN)* and the *Planning Guide*
- *Software Installation and Upgrade Guide*
- *Knowledge Builder*



## Complete these forms

*Software Installation and Upgrade Guide*

- Site specification form

**Step**  
**1**

## Upgrade Experion ACE

*Software Installation and Upgrade Guide: page 151*

# Upgrading Experion R101/R201 SIM-C200



## References

- Before you begin, read the *Software Change Notice (SCN)* and the *Planning Guide*
- *Software Installation and Upgrade Guide*
- *Knowledge Builder*



## Complete these forms

*Software Installation and Upgrade Guide*

- Site specification form

**Step**  
**1**

**Upgrade Experion SIM-C200**

*Software Installation and Upgrade Guide: page 154*

# Upgrading Experion R201 Console Stations and client applications



## References

- Before you begin, read the *Software Change Notice (SCN)* and the *Planning Guide*
- *Software Installation and Upgrade Guide*
- *Knowledge Builder*



## Complete these forms

- Software Installation and Upgrade Guide*
- Site specification form

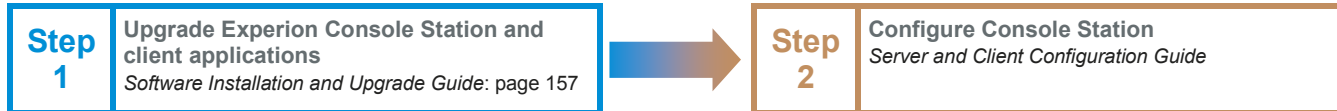

# Upgrading Experion R101/R201 Flex Stations and client applications



## References

- Before you begin, read the *Software Change Notice (SCN)* and the *Planning Guide*
- *Software Installation and Upgrade Guide*
- *Knowledge Builder*



## Complete these forms

- Software Installation and Upgrade Guide*
- Site specification form

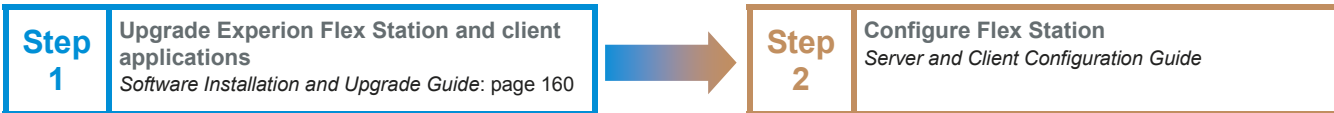

**Honeywell Process Solutions**

2500 West Union Hills Drive

Phoenix, AZ 85027

USA

[www.honeywell.com](http://www.honeywell.com)

EP-DCSX23

November 2004

© 2004 Honeywell International Inc.

**Honeywell**